



01452 690553



sales@applebys.estate



www.applebysestateagents.co.uk



52 Swan Road

, Gloucester, GL1 3BJ

£230,000

 2  1  2  E

This beautifully presented TWO/THREE bedroom period home is ready to move into! having undergone a complete renovation , benefitting TWO reception rooms, TWO double bedrooms 70ft (approx) rear garden. Situated in popular Kingsholm close to all the local amenities***CHAIN FREE***



Entrance

Lounge 12'5 x 10'7 (3.78m x 3.23m)

Dining Room 12'5 x 10'5 (3.78m x 3.18m)

Kitchen 10'10 x 7'6 (3.30m x 2.29m)

Bathroom

Bedroom 1 12'5 x 10'7 (3.78m x 3.23m)

Bedroom 2 12'5 x 10'6 (3.78m x 3.20m)

Bedroom 3 10'5 x 7'6 (3.18m x 2.29m)

OUTSIDE

Situated on a NO THROUGH ROAD on street permit parking
Gated side access to the rear landscaped garden large sandstone patio whilst the rest of the garden is mainly laid to lawn measuring approx. 70ft a gravelled area to the bottom ideal for garden shed or further seating area.

Services

Mains drainage and gas central heating (new combi boiler 2021)
Gloucester City Council tax band B

Tenure

Freehold

Area Map



Floor Plans

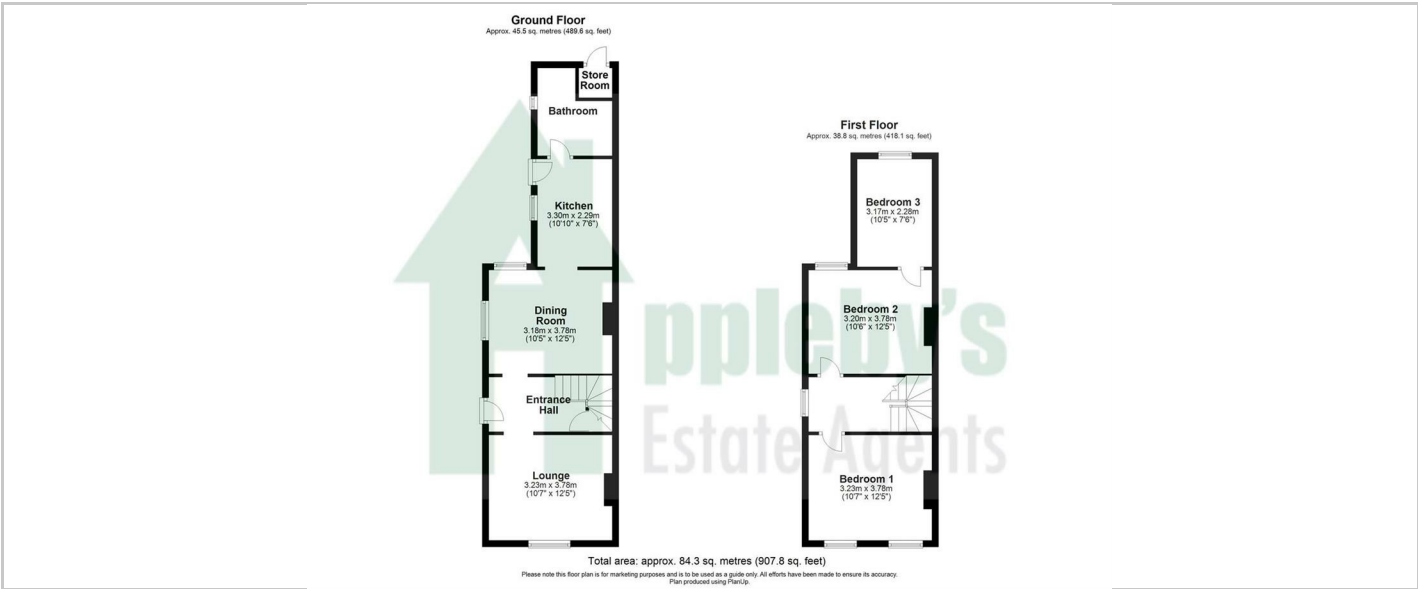

Energy Efficiency Graph

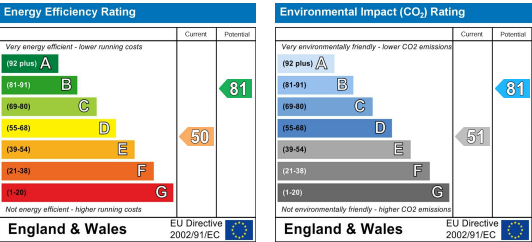

These particulars, whilst believed to be accurate are set out as a general outline only for guidance and do not constitute any part of an offer or contract. Intending purchasers should not rely on them as statements of representation of fact, but must satisfy themselves by inspection or otherwise as to their accuracy. No person in this firms employment has the authority to make or give any representation or warranty in respect